



XHRL series

XHRL 12360W 12V 360W



Valve Regulated Lead Acid Battery

Maintenance-Free Sealed Lead Acid Battery.
Absorbent Glass Mat (AGM) technology for efficient gas recombination of up to 99%.

Design for Standby Power Applications

| | |
|---|---|
| <p>【Design Life】 Up to 10 Years in Standby Service at 25°C Eurobat (20°C) : 10-12 years, Long Life</p> <p>【Operating Temperature Range】 Nominal Operating Temperature : 25°C (77°F) Discharge : -15°C ~ 50°C (5°F~122°F) Charge : -15°C ~ 40°C (5°F~104°F) Storage : -15°C ~ 40°C (5°F~104°F)</p> | <p>【Float Charging Voltage】 13.5 ~ 13.8 VDC/Unit at 25°C (77°F)</p> <p>【Equalization Charging Voltage】 14.4 ~ 15.0 VDC/Unit at 25°C (77°F)</p> <p>【Self Discharge】 Less than 10% after 90 days, can be stored up to 6 months at 25°C (77°F); Fully recharging is required before usage, and charged sooner if stored at higher temperature than 25°C (77°F).</p> |
|---|---|

| Specification | | Design according with IEC 60896-21/22:2004 | |
|---------------------------|---|--|-----------------|
| Nominal Voltage | 12V (6 cells per unit) | | |
| Nominal Capacity | 360W @15min-rate to 1.67V per cell @25°C (77°F) | | |
| Weight | Approx. 28.30 Kg (62.37 lbs) | | |
| Maximum Discharge Current | 800A (5sec) | | |
| Internal Resistance | Approx. 3.10 mΩ | | |
| Short Circuit Current | 2551A | | |
| Maximum Charge Current | 36A | | |
| Terminal types | I2 thread lead alloy terminal to accept M6 bolt | | |
| Terminal hardware Torque | 138.6 Kgf-cm / 120.3 Lbf-in / 13.58 N-m | | |
| Container Material | Flame Retardant Polypropylene (UL 94-V0) | | |
| Dimensions | Length (L) | 261.0±2.5 mm | 10.28±0.10 inch |
| | Width (W) | 168.5±2.0 mm | 6.63±0.08 inch |
| | Container Height (h) | 210.5±2.5 mm | 8.29±0.10 inch |
| | Overall Height (H) | 213.5±2.5 mm | 8.41±0.10 inch |

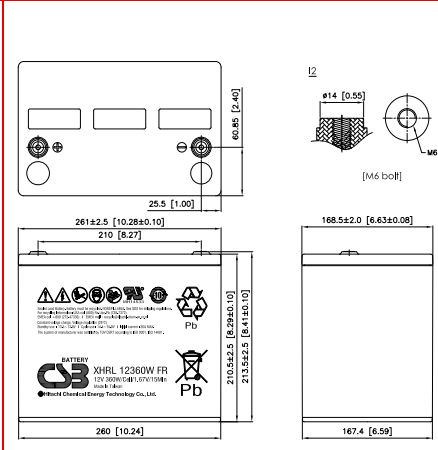

| Constant Current Discharge Characteristics Unit: A (25°C, 77°F) | | | | | | | | | | | | |
|---|------|------|------|------|------|-------|-------|-------|-------|-------|-------|-------|
| F.V/Time | 2MIN | 4MIN | 5MIN | 6MIN | 8MIN | 10MIN | 15MIN | 20MIN | 30MIN | 45MIN | 60MIN | 90MIN |
| 1.60V | 577 | 468 | 422 | 387 | 331 | 287 | 207 | 164 | 117 | 83.7 | 65.8 | 46.9 |
| 1.67V | 524 | 421 | 386 | 360 | 308 | 272 | 200 | 159 | 116 | 82.8 | 65.2 | 46.6 |
| 1.70V | 490 | 400 | 370 | 342 | 296 | 262 | 195 | 156 | 115 | 82.1 | 64.8 | 46.4 |
| 1.75V | 438 | 364 | 334 | 310 | 275 | 240 | 185 | 150 | 111 | 80.3 | 63.7 | 45.9 |
| 1.80V | 366 | 316 | 295 | 278 | 243 | 215 | 170 | 140 | 106 | 77.1 | 61.5 | 44.7 |
| 1.85V | 294 | 272 | 254 | 235 | 208 | 189 | 150 | 126 | 97.8 | 71.6 | 57.4 | 42.0 |

| Constant Power Discharge Characteristics Unit: W (25°C, 77°F) | | | | | | | | | | | | |
|---|------|------|------|------|------|-------|-------|-------|-------|-------|-------|-------|
| F.V/Time | 2MIN | 4MIN | 5MIN | 6MIN | 8MIN | 10MIN | 15MIN | 20MIN | 30MIN | 45MIN | 60MIN | 90MIN |
| 1.60V | 5772 | 4683 | 4324 | 3949 | 3419 | 3001 | 2295 | 1836 | 1340 | 966 | 766 | 552 |
| 1.67V | 5399 | 4381 | 4003 | 3701 | 3270 | 2864 | 2236 | 1799 | 1324 | 957 | 760 | 550 |
| 1.70V | 5100 | 4198 | 3844 | 3577 | 3170 | 2783 | 2198 | 1774 | 1312 | 951 | 757 | 548 |
| 1.75V | 4586 | 3834 | 3562 | 3355 | 2943 | 2617 | 2097 | 1708 | 1280 | 933 | 746 | 544 |
| 1.80V | 4067 | 3454 | 3277 | 3047 | 2671 | 2411 | 1936 | 1601 | 1225 | 900 | 723 | 531 |
| 1.85V | 3329 | 3038 | 2803 | 2625 | 2366 | 2184 | 1726 | 1453 | 1141 | 843 | 680 | 503 |

Please refer to the official site for the latest rating confirmation. URL: www.csb-battery.com

Issued: 170201

Sales Offices
日立化成能源科技股份有限公司
Hitachi Chemical Energy Technology Co., Ltd.

BUSINESS HEADQUARTERS
Tel: +886-2-2880-5600
Fax: +866-2-2888-3300

USA OFFICE
Tel: +1-817-244-7777 / 1-(800)3-CSB-USA (272872)
Fax: +1-817-244-4445

SHENZHEN OFFICE (CHINA)
Tel: +86-755-8831-6488, 8831-6775
Fax: +86-755-8831-6075

EUROPE (EMEA) OFFICE
Tel: +31(0)180-418-140
Fax: +31(0)180-418-327

SHANGHAI OFFICE (CHINA)
Tel: +86-21-5046-1622, 5046-0833
Fax: +86-21-5046-1046

TAIPEI OFFICE
Tel: +886-2-2880-5600
Fax: +866-2-2888-3300

BEIJING OFFICE (CHINA)
Tel: +86-10-5820-5336, 5820-5338
Fax: +86-10-5820-3053

Recognized under UL 1989,
and certified by ISO 9001, 14001.

